

Technical Data Hall 1.2

length	98 m
width	62 m
gross area m ²	6.045 m ²
clearance height	9,00 m
utility floor on a solid base	yes
solid floor with cable ducts	no
maximum permissible surface load	10 kN/m ²
fork lift and truck with wheel load	3,5 t
available intermediate ceiling	no
suspension points max. load 2 kN/pt.	yes
daylight from window	two sided (No continuous windows)
number of gates	4
entrance dimensions (width x height)	4,85 m x 5,30 m
gas connection possible	yes
cooling	yes
water connection up to 50 mm	yes
water drainage up to 100 mm	yes
firefighting system	sprinkler system
supports	yes
freight elevators	no

HALLDATA



Technical Data Hall 2.2

length	98 m
width	62 m
gross area m ²	6.045 m ²
clearance height	9,00 m
utility floor on a solid base	yes
solid floor with cable ducts	no
maximum permissible surface load	10 kN/m ²
fork lift and truck with wheel load	3,5 t
available intermediate ceiling	no
suspension points max. load 2 kN/pt.	yes
daylight from window	two sided (No continuous windows)
number of gates	4
entrance dimensions (width x height)	4,85 m x 5,30 m
gas connection possible	yes
cooling	yes
water connection up to 50 mm	yes
water drainage up to 100 mm	yes
firefighting system	sprinkler system
supports	yes
freight elevators	no

HALLDATA



Technical Data Hall 3.2

length	98 m
width	62 m
gross area m ²	6.045 m ²
clearance height	9,00 m
utility floor on a solid base	yes
solid floor with cable ducts	no
maximum permissible surface load	10 kN/m ²
fork lift and truck with wheel load	3,5 t
available intermediate ceiling	no
suspension points max. load 2 kN/pt.	yes
daylight from window	two sided (No continuous windows)
number of gates	4
entrance dimensions (width x height)	4,85 m x 5,30 m
gas connection possible	yes
cooling	yes
water connection up to 50 mm	yes
water drainage up to 100 mm	yes
firefighting system	sprinkler system
supports	yes
freight elevators	no

HALLDATA

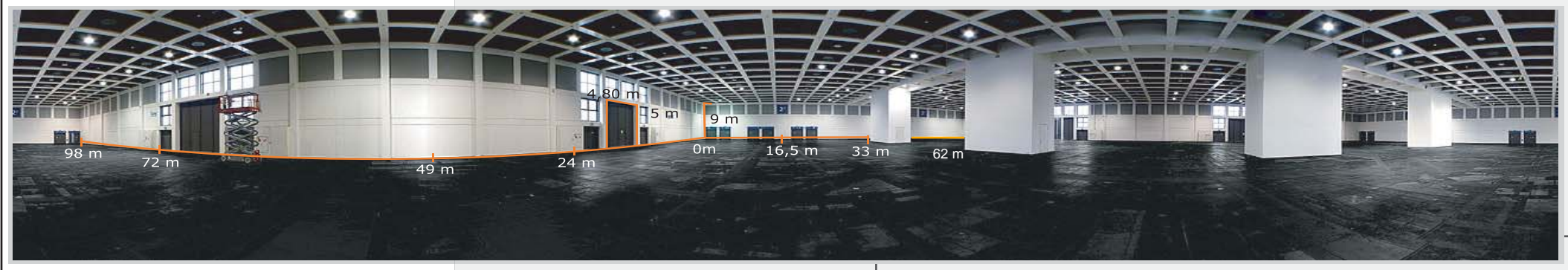

Technical Data Hall 4.2

length	98 m
width	62 m
gross area m ²	6.045 m ²
clearance height	9,00 m
utility floor on a solid base	yes
solid floor with cable ducts	no
maximum permissible surface load	10 kN/m ²
fork lift and truck with wheel load	3,5 t
available intermediate ceiling	no
suspension points max. load 2 kN/pt.	yes
daylight from window	two sided (No continuous windows)
number of gates	4
entrance dimensions (width x height)	4,85 m x 5,30 m
gas connection possible	yes
cooling	yes
water connection up to 50 mm	yes
water drainage up to 100 mm	yes
firefighting system	sprinkler system
supports	yes
freight elevators	no

HALLDATA

Halle 1.2 hall 1.2

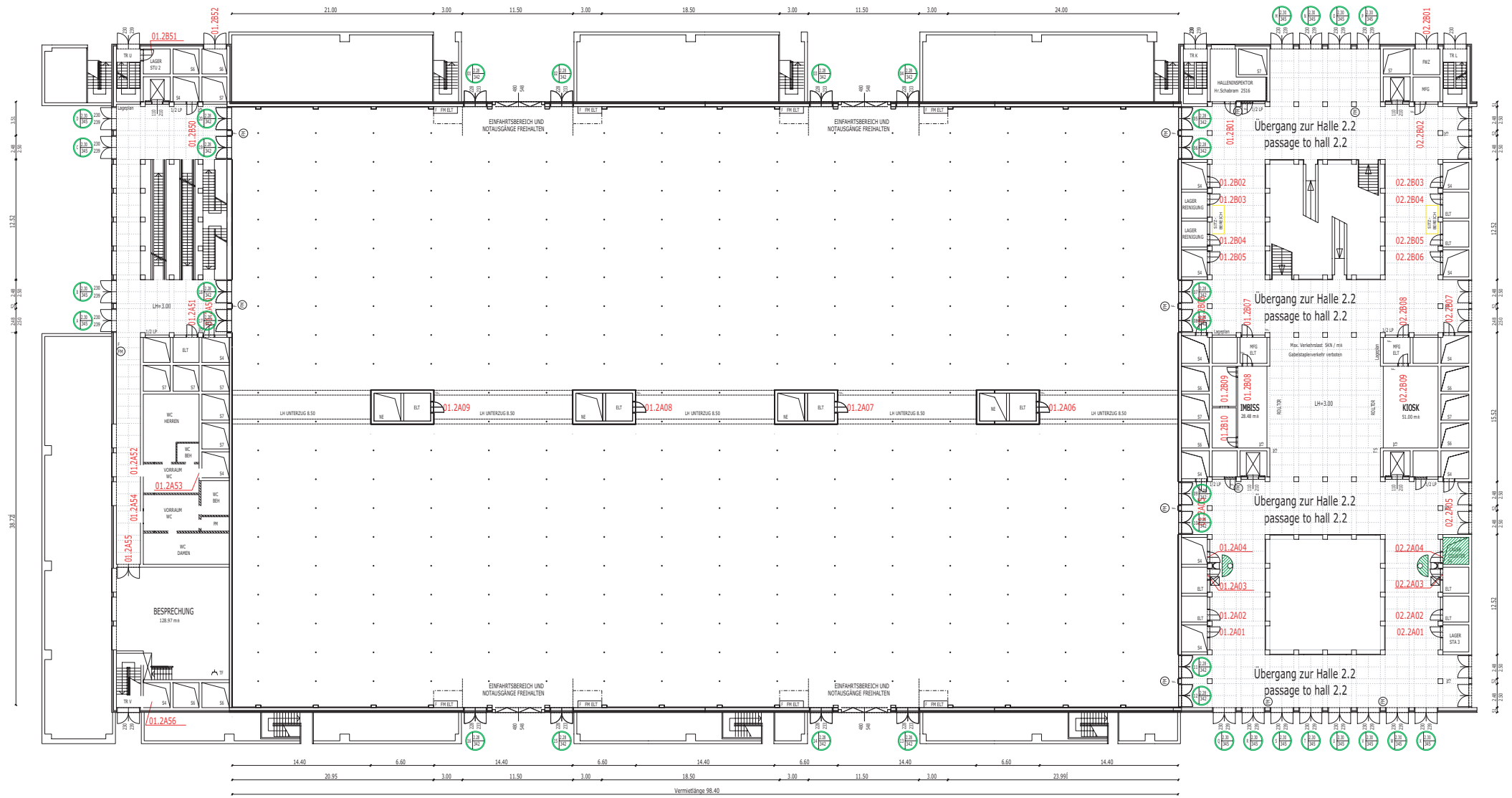

Halle 1.2 hall 1.2

- NA-Breite Anzahl Fluchtpersonen
- Vermietbarer Nebenraum
- Lagerraum Counter
- Standorte Counter

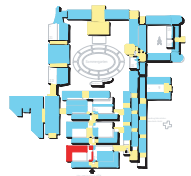

Halle 2.2

hall 2.2

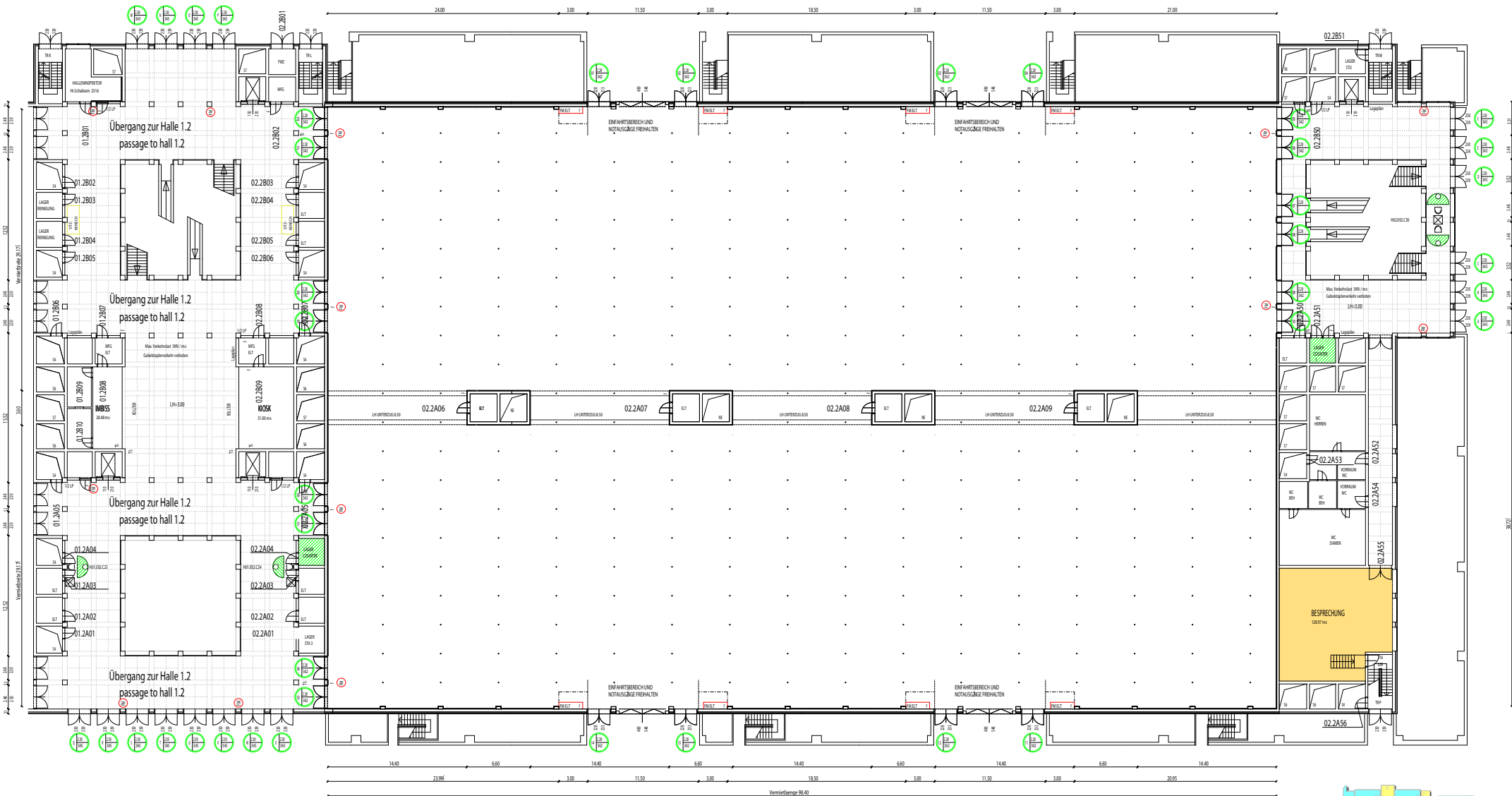

Halle 2.2

hall 2.2

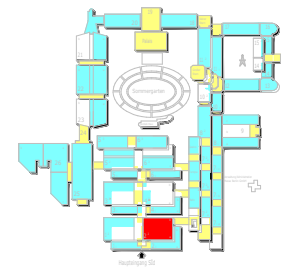

Halle 3.2 hall 3.2

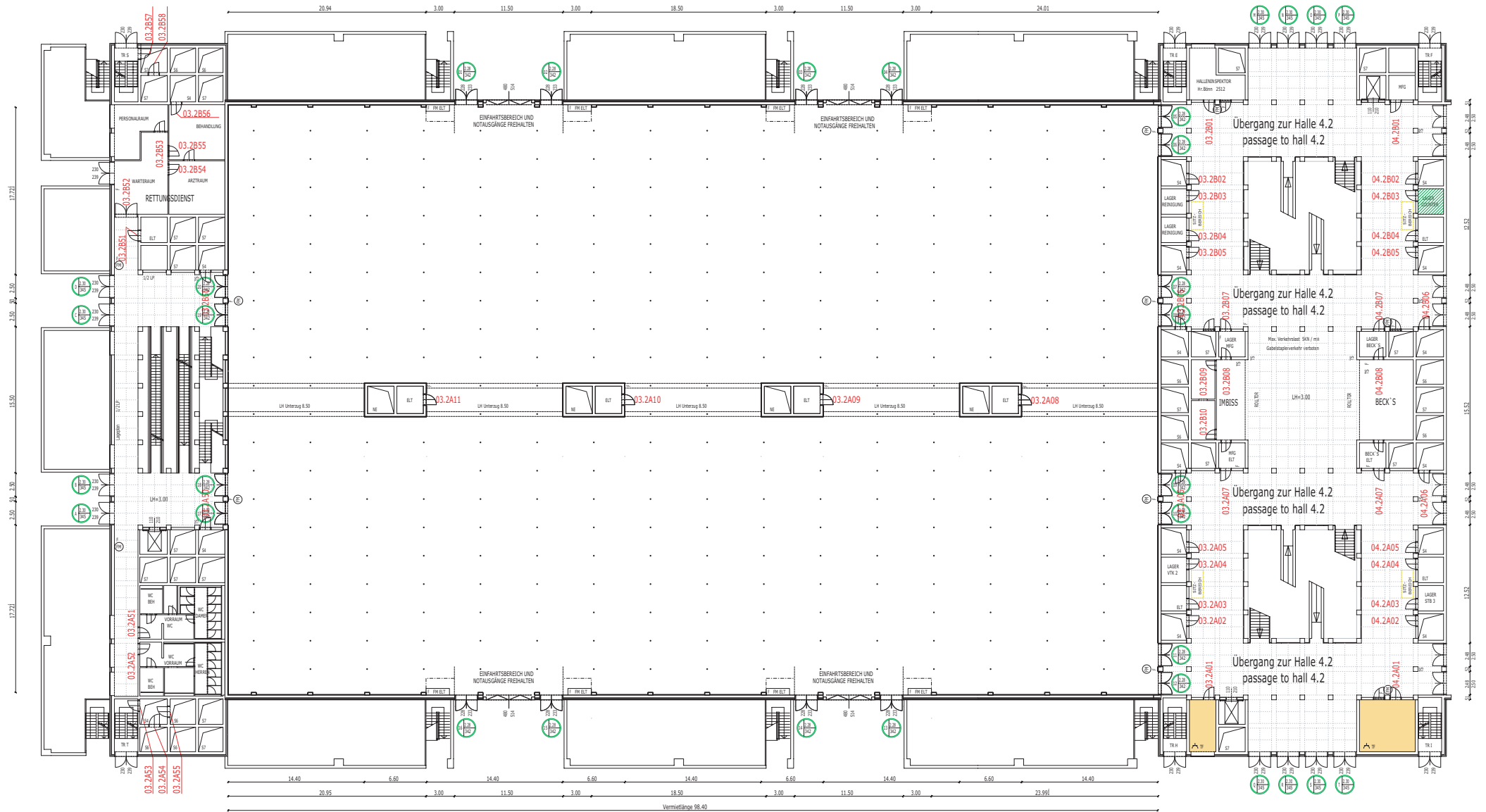

Halle 3.2 hall 3.2

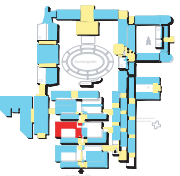

-  NA-Breite Anzahl Fluchtpersonen
-  Vermietbarer Nebenraum
-  Lagerraum Counter
-  Standorte Counter

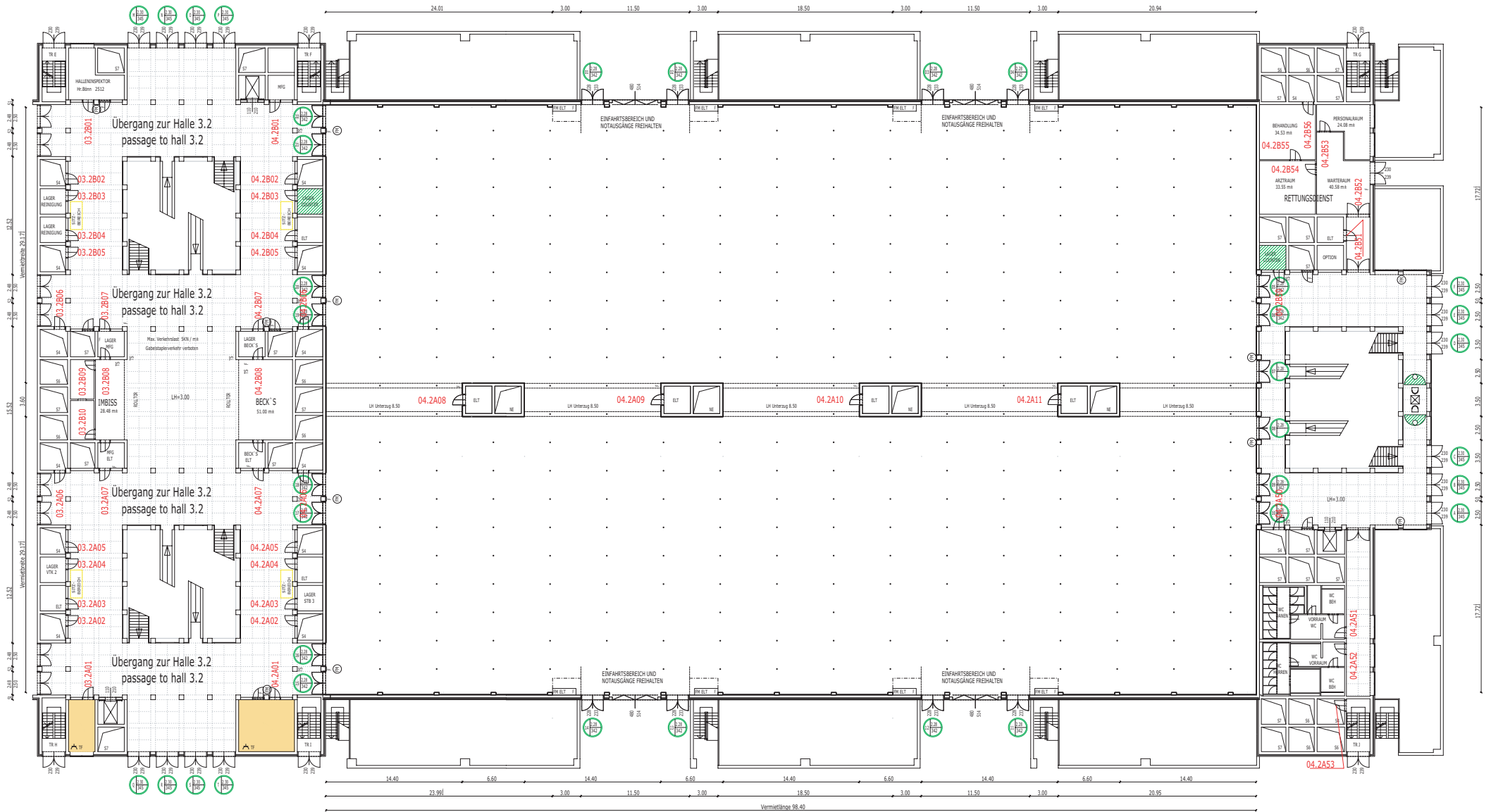

Halle 4.2 hall 4.2

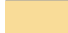

Halle 4.2 hall 4.2

-  NA-Breite Anzahl Fluchtpersonen
-  Vermietbarer Nebenraum
-  Lagerraum Counter
-  Standorte Counter

